

# Certificate Issue Web Site Manual: Firefox Edition

Revision History			
Rev.	Date (YYYY/MM/DD)	Description	Editor
V. 1.0	2015/4/1	First revision	NII
V. 1.1	2016/12/26	Amendment with addition of [NII Open Domain S/MIME CA] as a new Certificate Authority	NII
V. 2.2	2018/2/26	Addition of steps to change the language in the certificate retrieval procedure and amendment associated with the operating environment change.	NII
V. 2.3	2021/10/12	Change of issuance method by web enrollment.	NII

## Table of Content

- [1. Setting the Browser](#)
  - [1-1. Firefox Settings](#)
- [2. Retrieving the Certificate](#)
  - [2-1. Prerequisites](#)
  - [2-2. Certificate Retrieval](#)
    - [2-2-1. Notification of URL for the Certificate Retrieval](#)
    - [2-2-2. Retrieving the Certificate Using Firefox](#)

## 1. Setting the Browser

Sections to follow discuss how to set up the browser prior to using this system.

### 1-1. Firefox Settings

No prior settings are required with Firefox.

## 2. Retrieving the Certificate

### 2-1. Prerequisites

The prerequisites for retrieving the Certificate are described. Replace the technical terms according to the user environment in which the Certificate will be retrieved.

(The procedures required for Mozilla Firefox 58 are described in this document.)

#### Prerequisites

1. You have the Access PIN issued by the certificate use administrator;
2. you have received the e-mail designating the certificate retrieval URL; and
3. Mozilla Firefox is installed.

### 2-2. Certificate Retrieval

#### 2-2-1. Notification of URL for the Certificate Retrieval

Once you complete the certificate application, you will receive the e-mail from this system that notifies the certificate retrieval URL for the certificate download.

Access the certificate URL in the e-mail message and retrieve the certificate.

#### Notification of URL for the Certificate Retrieval

[Title]

client certificate issue acceptance notice

snip

**# Please find below the URL for the requested certificate retrieval.**

Please download a client certificate accessing the following certificate acquisition URL.

Please correctly enter access PIN acquired at 1) for request of entering access PIN accessing the certificate acquisition URL.

The download of a certificate is going to start as the authentication by the access PIN is completed.

**certificate acquisition URL:**[https://scia.secomtrust.net/~\\*\(https://scia.secomtrust.net/~\)](https://scia.secomtrust.net/~*(https://scia.secomtrust.net/~)) + <- **Access this URL to retrieve the Certificate.**

snip

## 2-2-2. Retrieving the Certificate Using Firefox

Retrieving the Certificate using [Firefox] is described.

### Process of Issuing the Certificate Using Firefox



**By specifying the web browser used for this system as the [Default] web browser, failure of the client authentication (including access failures) should be prevented.**

In this document, setting up the following prior to retrieving the certificate is recommended.

With Firefox, click on the Menu icon and select [Options] to get the Options screen.

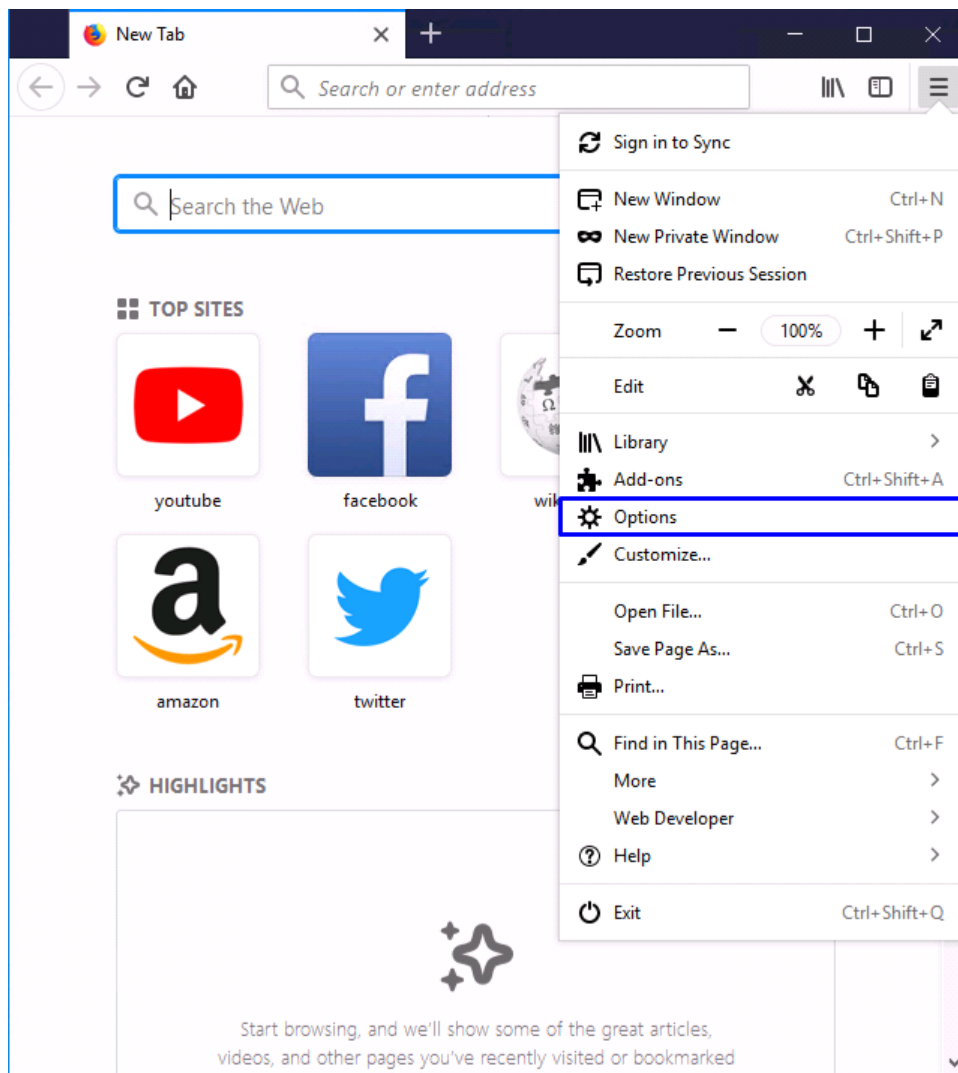

IN the [General] screen, click [Make Default...] in the [Startup] field.

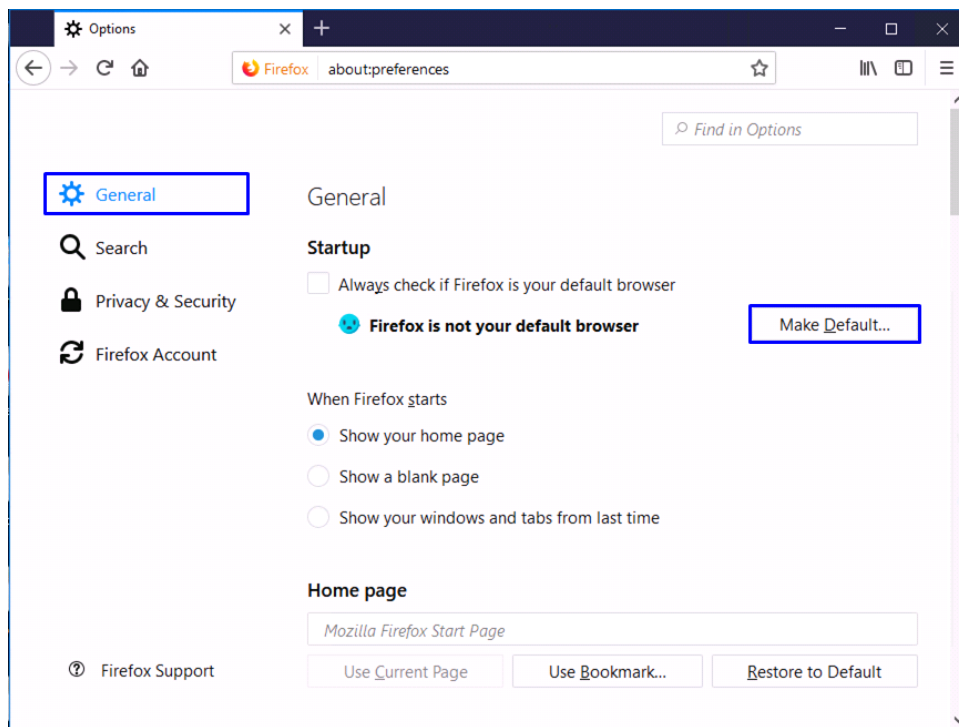

1. According to the instruction in [2-2-1. Notification of URL for the Certificate Retrieval], access the certificate retrieval URL provided in the e-mail.  
In the password prompt, enter the Access PIN you have received.

<<Retrieving for a new/lost certificate?>>

If you get the [User Identification Request] dialog box to select the digital certificate, click [Cancel].

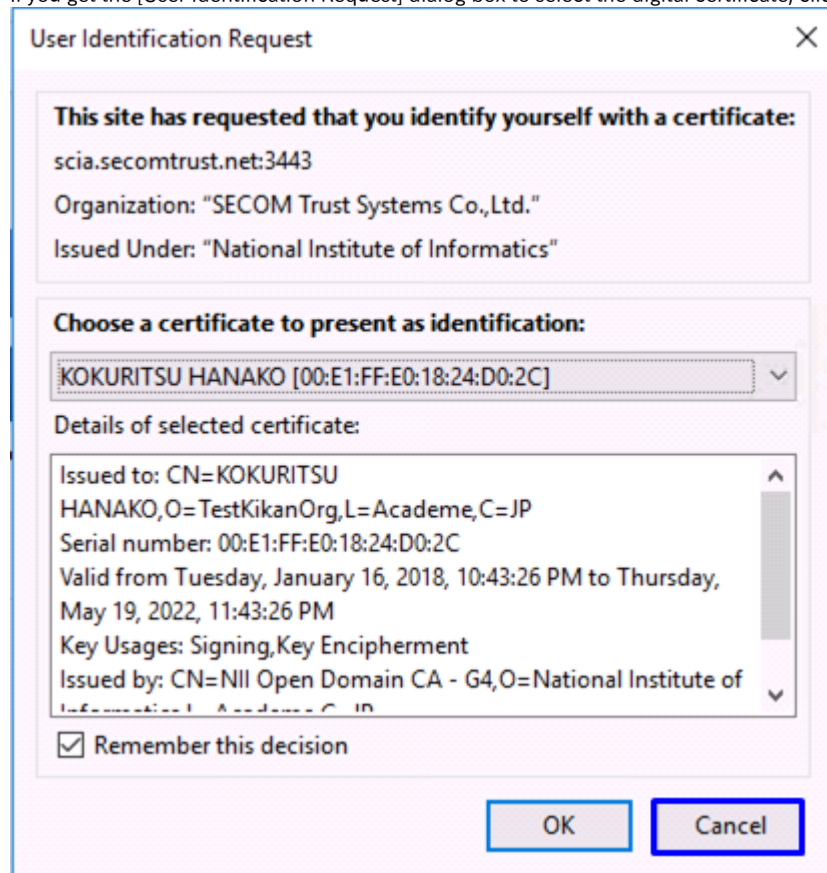

<<Updating for an expiring certificate?>>

If you already have a certificate and are updating that, select the one in current use in the certificate choice field.

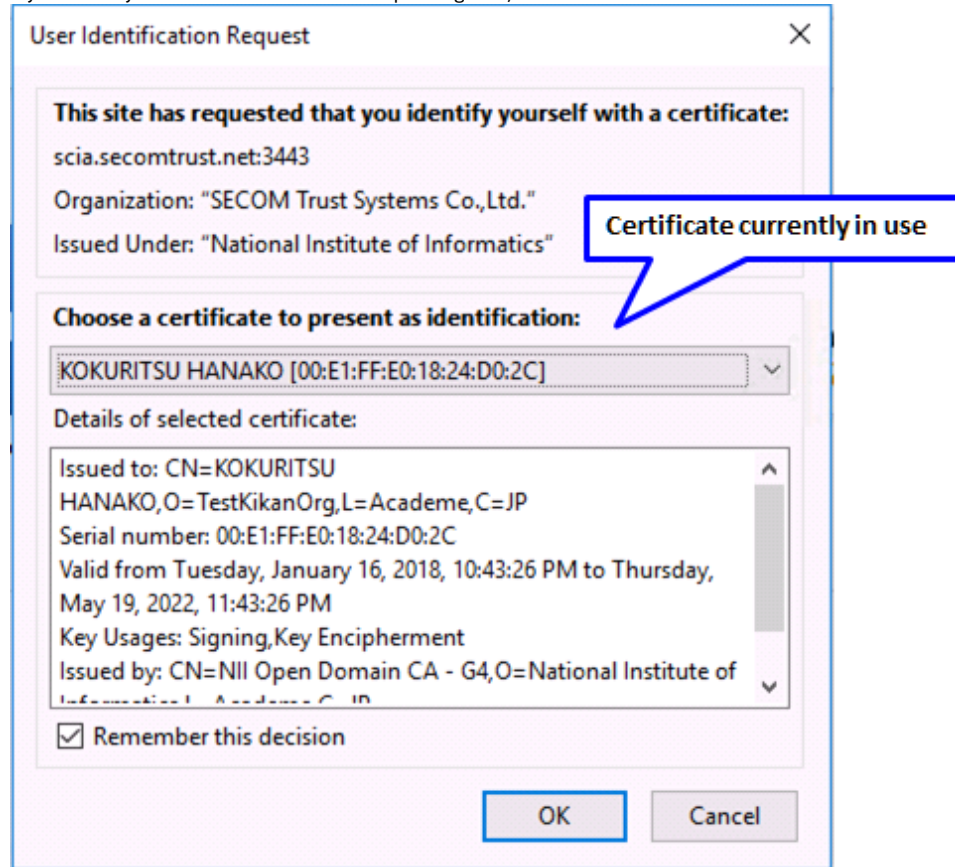

2. According to the instruction in [2-2-1. Notification of URL for the Certificate Retrieval], access the certificate retrieval URL provided in the e-mail.

In the password prompt, enter the Access PIN you have received.

情報・システム研究機構  
国立情報学研究所  
National Institute of Informatics

National Institute of Informatics  
UPKI Digital Certificate Issuance Service

[日本語](#) / [English](#)

Client Certificate Download [STEP1]

To issue the certificate, follow the steps.  
[STEP1] Enter the Password.  
[STEP2] Issue a certificate.  
[STEP3] Take a Certificate.

[STEP1] Enter the Password.

Please obtain the access PIN from the administrator and enter it below.

Password :

Next

- To change the language, click the link in the upper right corner.

Clicking [日本語 (Japanese)] changes the language to Japanese.  
Clicking [English] changes the language to English.

3. Now, the screen changes to the [Issue a Certificate] screen, make sure that the certificate is actually downloaded.

情報・システム研究機構  
国立情報学研究所  
National Institute of Informatics

National Institute of Informatics

UPKI Digital Certificate Issuance Service

● Client Certificate Download [STEP2]

To issue the certificate, follow the steps.

[STEP1] Enter the Password.

[STEP2] Issue a certificate.

[STEP3] Take a Certificate.

[STEP2] Issue a certificate.

Please click the [issue] button.  
This process may take several minutes.

Previous

Issue

Caution:

Once you click [Issue] button, please wait for until [STEP3] is shown.  
Please don't close your browser. And also, do not click the [Previous] button. The  
certificate might be unavailable.

4. If the certificate is successfully issued, the certificate will start downloading.  
When the download is complete, click the "X" button on your browser to close the browser.

情報・システム研究機構  
国立情報学研究所  
National Institute of Informatics

**National Institute of Informatics  
UPKI Digital Certificate Issuance Service**

---

● **Client Certificate Download [STEP3]**

To issue the certificate, follow the steps.

[STEP1] Enter the Password.  
[STEP2] Issue a certificate.  
[STEP3] Take a Certificate.

---

[STEP3] Take a Certificate.

The certificate has just been issued.  
please exit the browser used.

<The certificate actually downloaded>

Certificate Manager

Your Certificates   People   Servers   Authorities   Others

You have certificates from these organizations that identify you

Certificate Name	Security Device	Serial Number	Expires On	
National Institute of Informatics				
Admin	Software Security Device	72:1D:83:80:43:8D:0C:6C	Wednesday, July 6, 2022	

View...   Backup...   Backup All...   Import...   Delete...

OK



Refreshing your Firefox will delete the captured certificate. Be careful and well reminded that you have to redo all relevant steps (from requesting through certificate issuing and install) if the certificate is lost by the deletion.



**If the [Select a Certificate] dialog box will not pop up, you need to set up the following.**

Click the [Tools] icon -> select [Options] -> [Privacy & Security] menu, and select [Ask you every time (A)] for [When a server request your personal certificate] in the [Certificate] field.

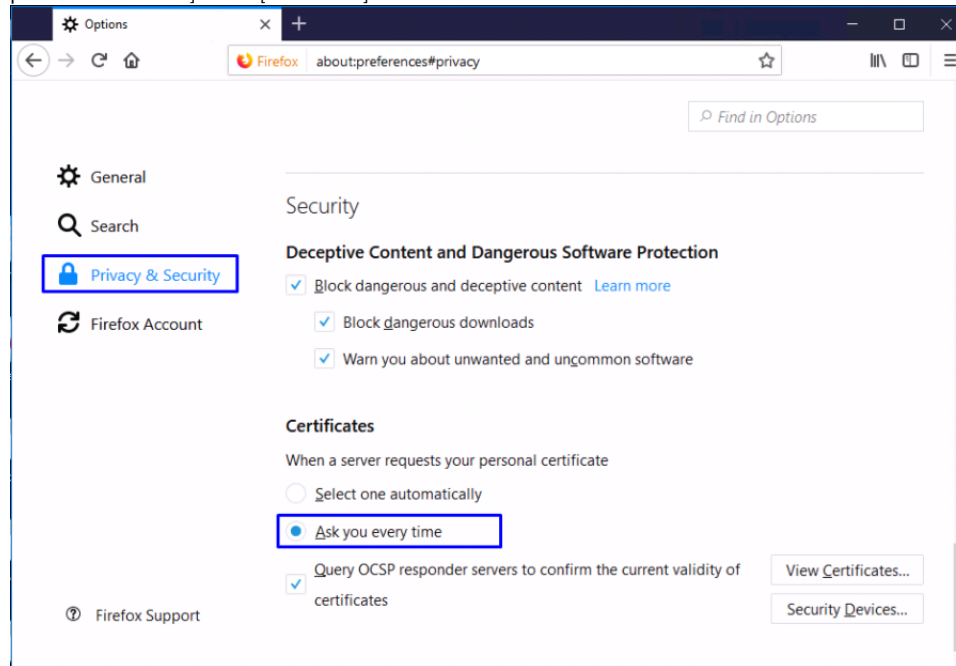

**Refreshing your Firefox will delete the captured certificate.**

**Be careful and well reminded that you have to redo all relevant steps from requesting through certificate issuing and install if the certificate is lost by the deletion.**